

**Saimaavillage**



# **Holiday Resort area in Savonlinna Finland**

**103 hectares of land with 8500 sqm<sup>2</sup>  
building area at Lake Saimaa.**

**1. The Island 97,5 ha**

**7710 sqm<sup>2</sup> building rights.**

**Distance from mainland only 200 meters.**

**2. Small Island 3,2 ha**

**3. Mainland Area 2,8 ha**

**800 sqm<sup>2</sup> building rights.**

A scenic view of a lake at sunset. The sun is low on the horizon, casting a golden glow over the water and the surrounding landscape. The water is calm, reflecting the sun and the sky. In the background, there are mountains and a dense forest of evergreen trees. A small island with a few trees is visible in the middle of the lake. The foreground shows rocky terrain with some greenery.

**Saimaavillage concept is luxury eco resort hotel for active people who love nature, silence and privacy. Situated in the middle of lake district´s archipelago, Saimaavillage offers a wonderful environment for nature enthusiasts to find more about Finnish Lakeland.**



# Master plan proposal.

Architectural  
planning is  
part of the  
experience.

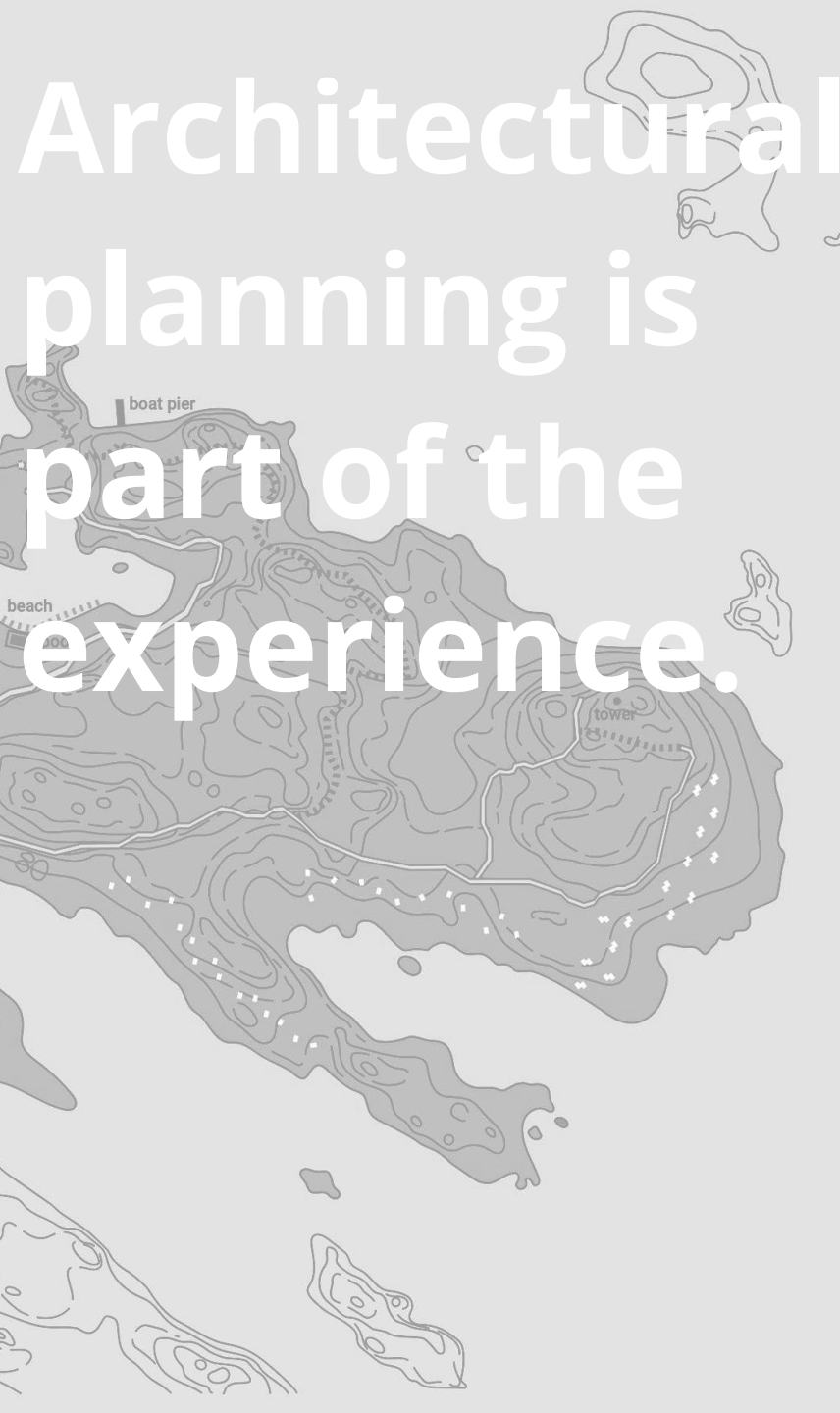



**In the middle of Saimaa.  
Surrounded by nothing but  
nature.**



**Hotel concept is based on luxury and privacy.**





**The buildings are easy to  
install and modify.**



Villas.



**Each plot has 240 m<sup>2</sup>  
building rights.**



**Feel the silence.**



**View point.**



**Reception + service +  
shopping.**



**Floating elements.**

**Piers, activities, restaurant**



**Beach, pool and saunas.**





**Sparkling, pure waters of  
Lake Saimaa.**



**Arrival to island by steam  
ship cruise.**



**Boat cruises for smaller groups.**

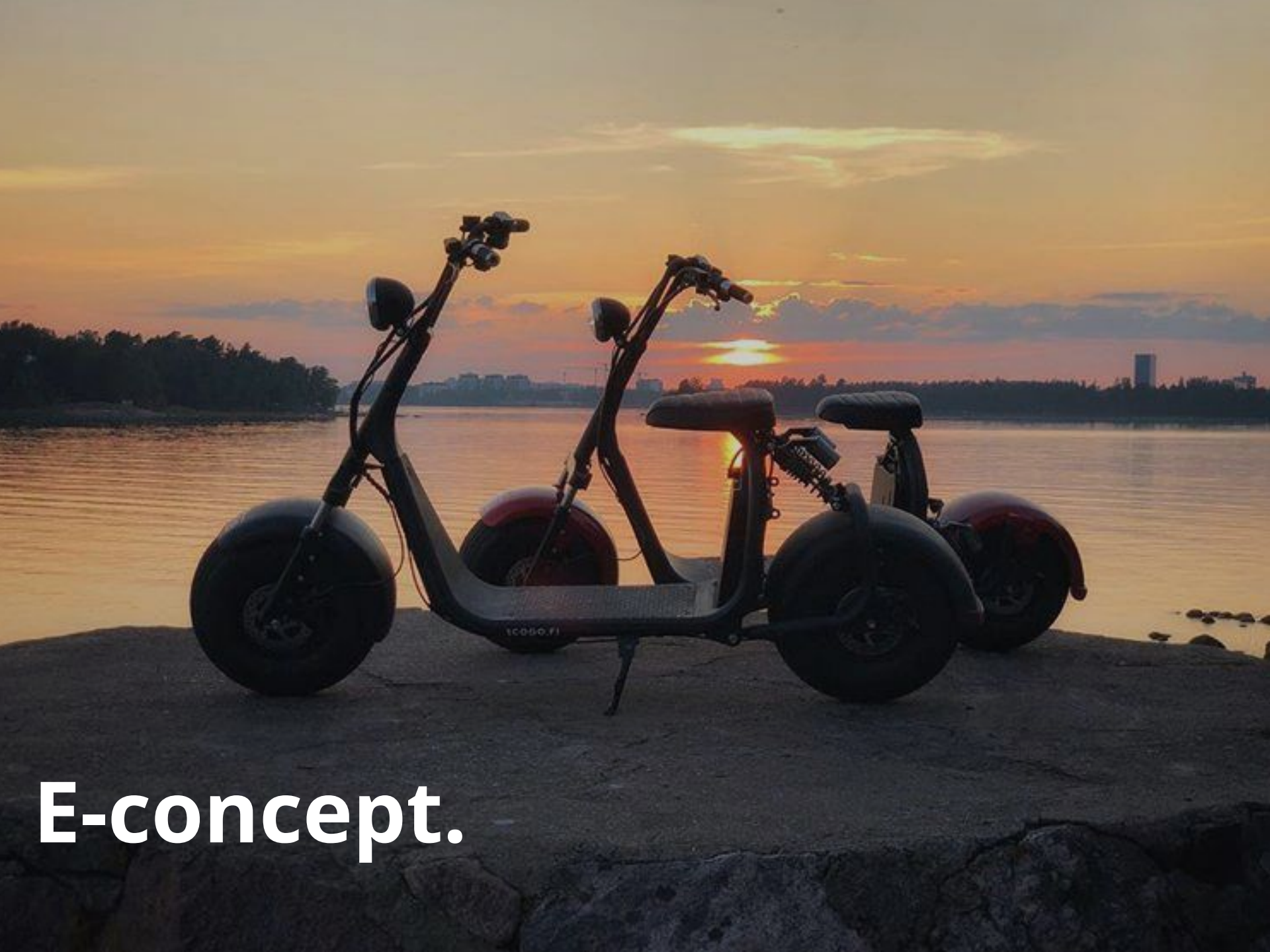

**E-concept.**

# Solar greenpower

hydroponic gardening, recycling

# Electric energy

environment

# Combination of tourism, research and education

carbon storage



**E-boating, sup, kayaks.**

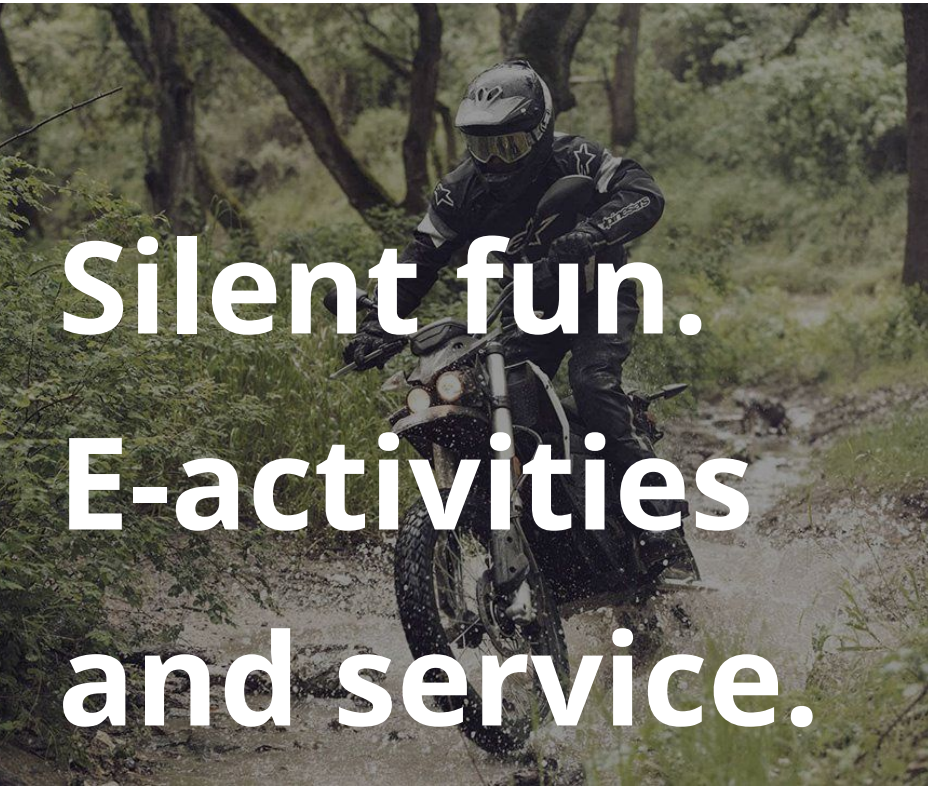

**Silent fun.  
E-activities  
and service.**





**Electric ferry.**



**Ride smart.**



A close-up photograph of a forest floor. The ground is covered with a dense layer of green moss, interspersed with dry, brown leaves and pine needles. A small, vibrant red berry is visible on a green stem in the lower-left quadrant. The text "From forest to table." is overlaid in white, bold, sans-serif font across the center of the image.

**From forest to table.**



**Superfood on super island.**



**Chaga and other nature  
healing products directly  
to customers.**



**Forest surrounded by 10  
km of shore line. Unique.**



**Fishing activities at all seasons.**



**Sup boarding.**



**Winter sports.**





**Snow walking.**

Winter speed.



**Just do it.**





**Thank you!**

**[info@saimaavillage.fi](mailto:info@saimaavillage.fi)**

**+(358) 50 553 0366**

**[www.saimaavillage.fi](http://www.saimaavillage.fi)**